



INNOVATIVE SIGNAGE PRODUCTS



INNOVATIVE SIGNAGE PRODUCTS TO MAKE YOUR JOB EASIER

Welcome to our range of innovative signage products, each carefully designed and selected to ensure quality, performance and value, making your next project quicker and easier. Our range is always growing so if you don't see it here, phone our sales line – we'll be glad to help.



CONTENTS

Pavement Signs	4
A-boards	8
Standing Flags	10
Wall Flags	12
Sign Holders	13
Cable Tension System	14
Wall Mounts	16
Poster Hangers	19
Media Tensioning System	20
Pivot Pricers Slot Signs	21
Light Boxes White Boards	22
Display Frames	23
Display Stands	26
More Innovative Signage Products	29
Pavement Sign Panel Sizes	30

ZIVA



Easy to position

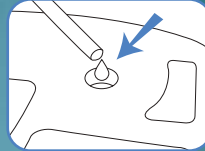

Water filled base

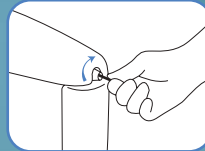

Lockable

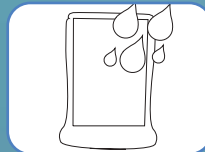

Weatherproof



ZIVA



ULTRO

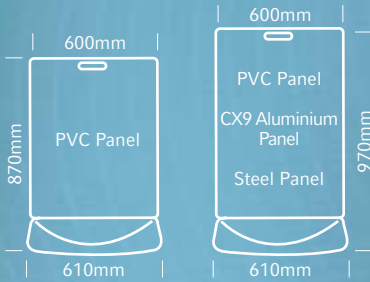

ULTRO



Easy to position

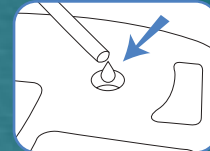

Water filled base

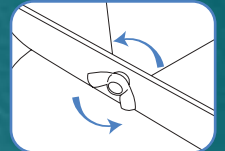

Panel secured with wingscrew



“The Ultro wheel option makes moving the sign really easy – even when fully weighted”

BASE COLOUR GUIDE



Check below for base colours available.
Colours are indicative only.

INFORMER

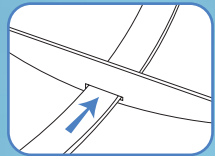
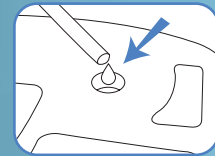

INFORMER

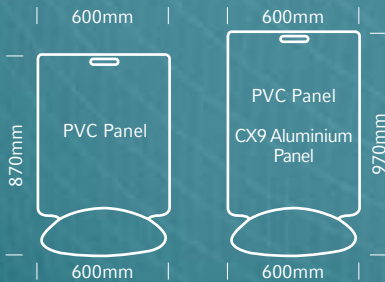

PAVEMENT SIGNS

ZIVA

A completely new message in under a minute

- Displays 2 x A1 posters or digital prints
- Posters can be changed out easily - no tools required
- Unit locks to protect posters
- 100% weatherproof
- Comes with wheels for easy positioning
- Mould-in base logos available - minimum quantities apply
- Stock base colours - White Haze, Graphite, Red, Orange, Yellow, Dark Blue

ULTRO

The ultimate pavement sign

- Wheel option available for easy positioning
- Panel locks into place with stainless steel wingscrew
- Panels can be easily interchanged
- Available with 800mm and 900mm PVC panels
- Also available with 900mm CX9 powdercoated aluminium panels in White, Black, Yellow, Tomato Red, Dark Blue, Metallic Silver
- Steel panels also available for magnetic signage. Powdercoated Black or White
- Water fillable base gives up to 17kg weight for maximum stability
- Smaller footprint than other bases available - less pavement obstruction
- Mould-in base logos available - minimum quantities apply
- Stock base colours - Black, White, White Haze, Graphite, Red, Orange, Yellow, Dark Green, Lime Green, Dark Blue, Light Blue, Purple

INFORMER

Dome-shaped water fillable base

- Panel locks into place with PVC tab
- Panels can be easily interchanged
- Available with 800mm and 900mm PVC panels
- Also available with 900mm CX9 powdercoated aluminium panels in White, Black, Yellow, Dark Blue, Metallic Silver
- Water fillable base
- Stock base colours - Black, White, Red, Orange, Yellow, Dark Green, Light Green, Royal Blue, Light Blue, Magenta

EXECUTIVE

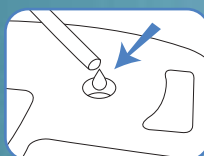

Water filled base

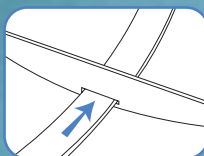

Panel secured with tab

EXECUTIVE

Classic shape water fillable base

- Panel locks into place with PVC tab
- Panels can be easily interchanged
- Available with 800mm and 900mm PVC panels
- Water fillable base
- Stock base colours - Black, White, Yellow, Orange, Royal Blue, Light Blue, Dark Green, Light Green, Magenta

DIRECTOR

- Friction-fit panel design
- Panels can be interchanged
- Water fillable base
- Stock base colours - Black, White

MESSENGER

The lightweight yet stable alternative

- Unique base design gives good stability
- Panels can be interchanged
- Easily portable
- Three sizes available - 600mm x 800mm, 500mm x 600mm, and 400mm x 500mm

DIRECTOR

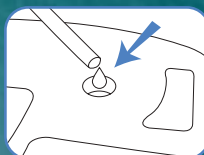

Water filled base

ORBIS SPINNING SIGN

Add movement to your message

- Water weightable base for super stability
- Base includes wheels, making it easy to position
- Available with optional top display panel
- Long life construction - stainless steel fastenings, plated and powdercoated frame and PVC panels
- Stock base colour - Graphite

For detailed panel dimensions refer to Page 31

BASE COLOUR GUIDE



Black



White



Yellow



Orange



Dark Green



Light Green



Royal Blue



Light Blue



Magenta



Graphite

Check product descriptions for base colours available. Colours are indicative only.

EXECUTIVE

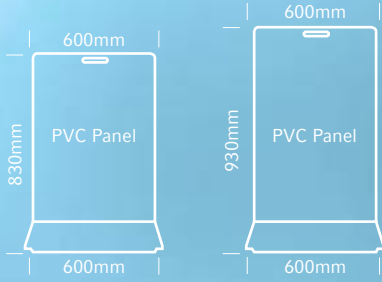

DIRECTOR

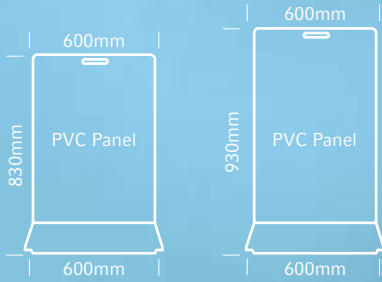

MESSENGER

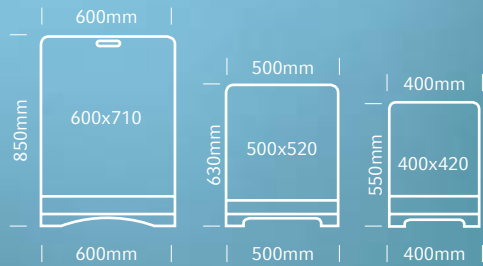

MESSENGER



ORBIS SPINNING SIGN

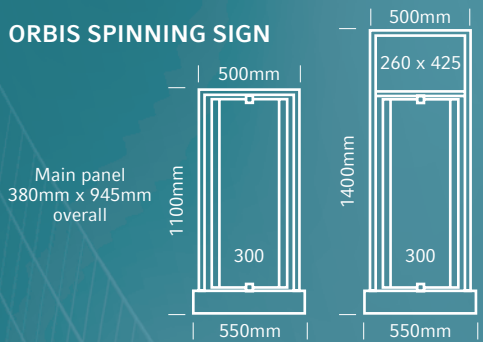

ORBIS SPINNING SIGN



ORBIS SPINNING SIGN AVAILABLE WITH OR WITHOUT STATIC TOP PANEL



“Adding movement to our message has helped differentiate our stores and created more awareness”

ADVERTISER

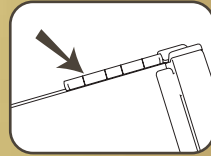
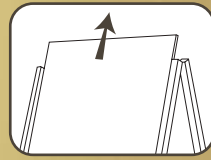

Non-rust hinges

ADVERTISER

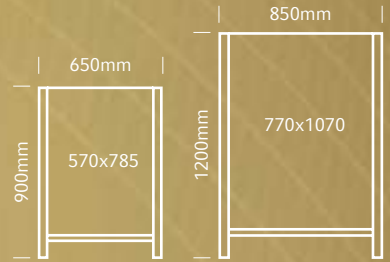

JUMBO SAFETY BOARD



PIONEER

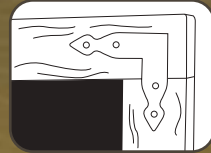

Rustic finish

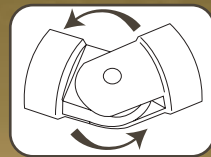

Non-rust pivot hinges

PIONEER



SAFETY A-BOARD

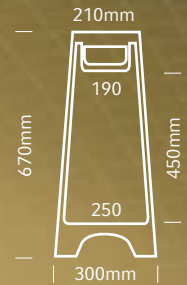

ENDUROSIGN

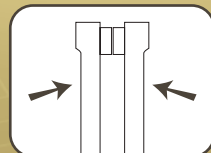
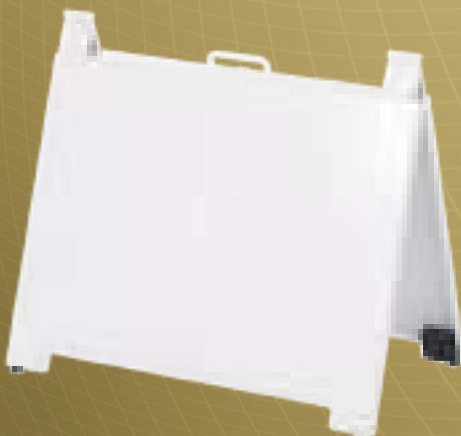

Panels fold face to face, yet never touch. No scratching possible

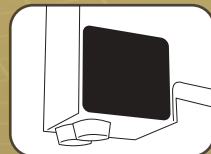

Feet weighted for stability

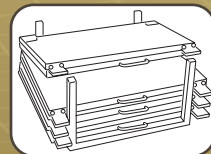

Stores flat in specially designed car boot rack. Holds 5 signs

ENDUROSIGN

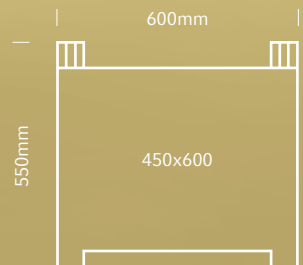

FLUTE A-BOARD

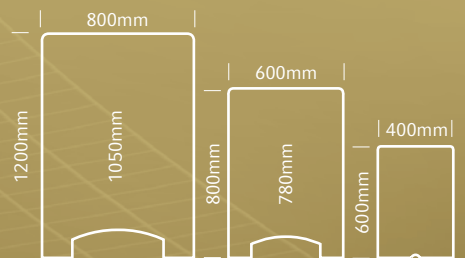

JUMBO SAFETY BOARD

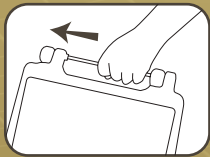

Easily portable

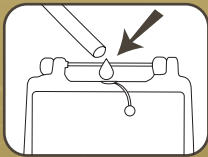

Water weightable

SAFETY A-BOARD

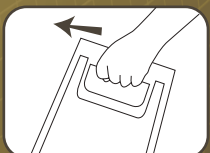

Easily portable

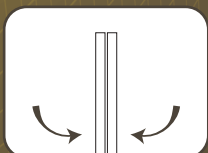

Folds flat

FLUTE A-BOARD

“Ideal for safety, directional or promotional messages”



A - B O A R D S

ADVERTISER

Strong durable A-Boards

- Panels easily interchanged or reversed
- Stainless steel components
- Durable powdercoated finish
- 2 sizes available - 600 x 900mm and 800 x 1200mm
- Panel colours - Black, White
- Frame colour - Silver

PIONEER

Natural, rustic timber A-Board

- Available with White, Black or Chalkboard panels
- Panels can be interchanged
- Non rust hinges and components
- Oiled to preserve the natural timber look

ENDUROSIGN

The toughest A-Board available

- Guaranteed tougher - will not rot, dent, warp or crack
- Moulded from Engineering Grade Plastics
- Easily portable
- Weighted, non slip feet for stability
- Panels fold face to face protecting the graphics. No scratching possible
- Car boot rack available to hold up to five signs
- Stock colours - Black, White, Safety Yellow

JUMBO SAFETY BOARD

Stable and durable safety message board

- Moulded in UV resistant PVC
- Suitable for interior or exterior use
- Folds flat for easy storage
- Holds up to 12 kgs for super stability
- Stock colour - Grey

SAFETY A-BOARD

Ideal for safety, warning or promotional messages

- Moulded in UV resistant PVC
- Suitable for interior or exterior use
- Folds flat for easy storage
- Stock colour - Safety Yellow

FLUTE A-BOARD

UV stabilised 6mm flute board construction

- Strong yet lightweight
- Folds flat for transport and storage
- 3 sizes available - 400 x 600mm, 600 x 900mm and 800 x 1200mm
- Stock colour - White

TELESCOPIC FLAG

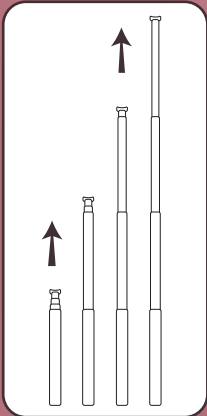

Telescopic adjustable height

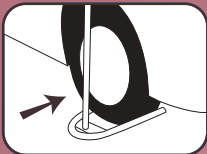

Comes with underwheel mount

SPINNAKER FLAG

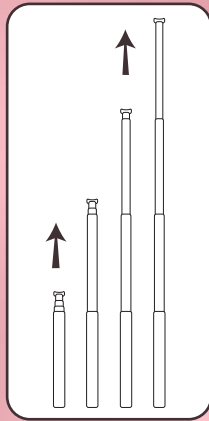

Telescopic

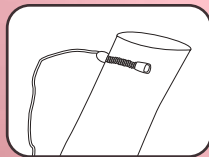

Comes with carry bag

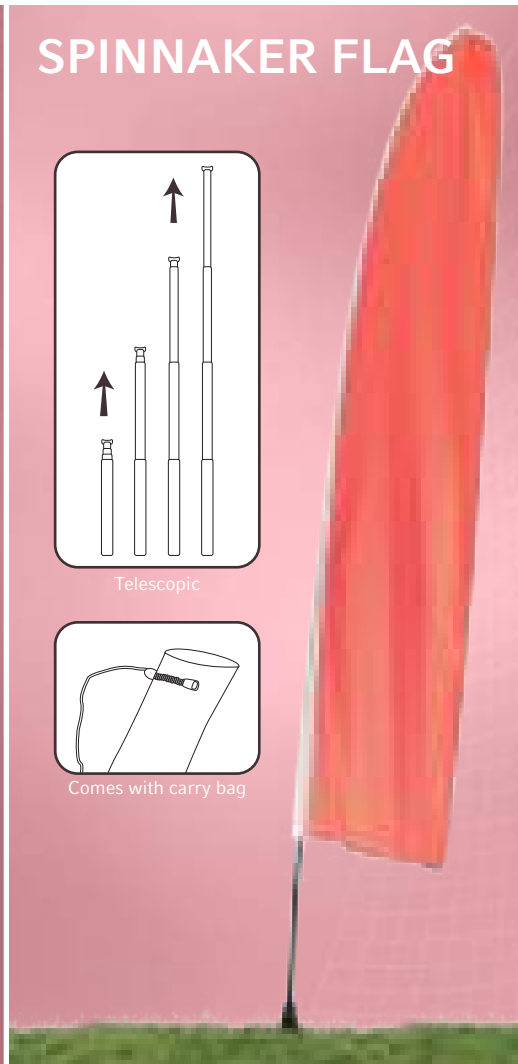

CURVED FLAG

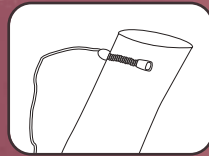

Comes with carry bag

STANDING FLAGS

TELESCOPIC FLAG

- 5.5m height for maximum impact
- Can also be used at 4m high
- Suggested flag size - 3000mm x 1170mm
- Telescopes down to 1.4m

SPINNAKER FLAG

- 4.5m high when flag is fitted
- Telescopic fibreglass pole system
- Ground mount is easily installed - no tools required
- Telescopes down to 1.2m
- Comes complete with carry bag

CURVED FLAG

- 2.8m high
- 3 piece powdercoated pole system
- Available with groundmount or 13 litre water fillable base
- Comes complete with carry bag

AERO FLAG

- 3.6m high - can also be used at 2.4m
- Suggested flag size - 1800mm x 900mm
- Anodised aluminium poles
- Available with groundmount or underwheel mount
- Comes complete with carry bag

TELESCOPIC



SPINNAKER



AERO FLAG

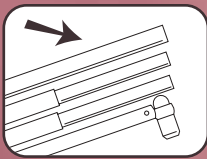
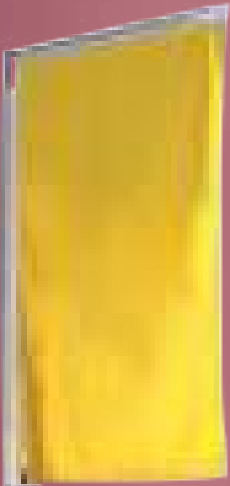

Easily portable

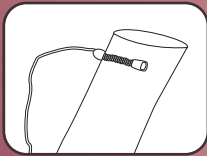

Comes with carry bag

FLANNERS



Heavy duty base is easy to position

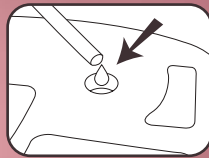

Two water filled base options

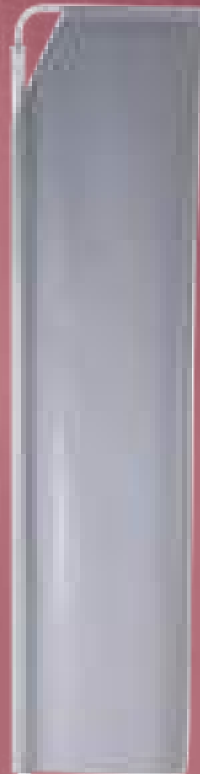

Groundmount



Standard



Heavy Duty

FLANNERS

Get your message above pavement obstructions

- Panels move in the breeze to attract more attention
- Panels can be easily interchanged
- Three standard base options
 - Groundmount for unpaved areas
 - Standard water fillable
 - Heavy Duty water fillable - stable in all conditions
- Stock panel colours - Black, Blockout White, Red, Grey, Orange, Yellow, Dark Green, Dark Blue
- Message reads right way on both sides
- Heavy duty base includes wheels

FLANNERS

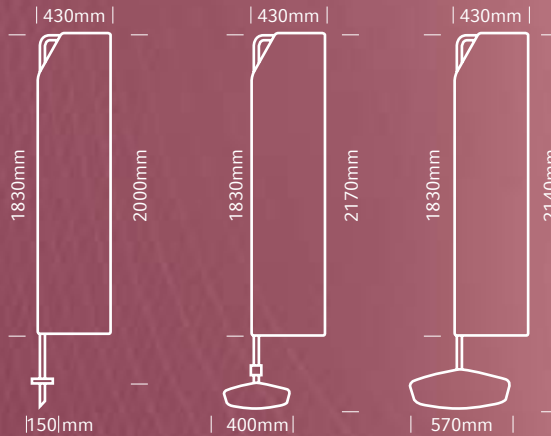

FLANNER PANEL COLOURS



Colours are indicative only.

CURVED

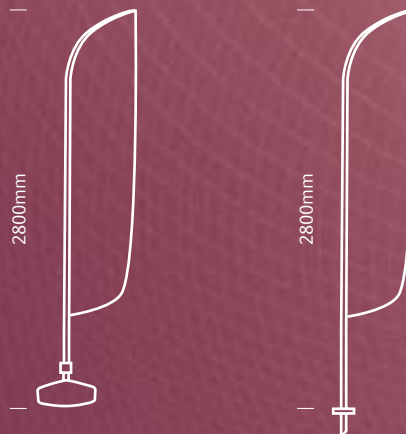

AERO

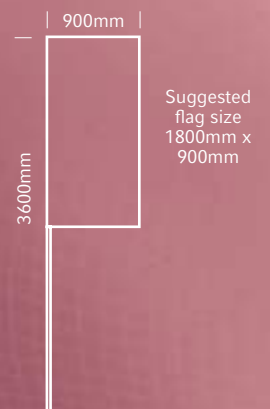

POS FLAGS

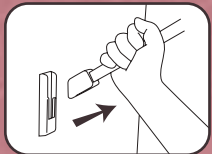

Easily detachable

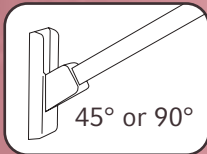

Adjustable - 45° or 90°

WALL FLAGS

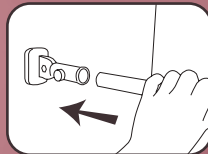

Easily detachable

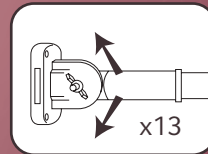

Adjustable - 13 positions

STREET FLAGS



POS FLAG

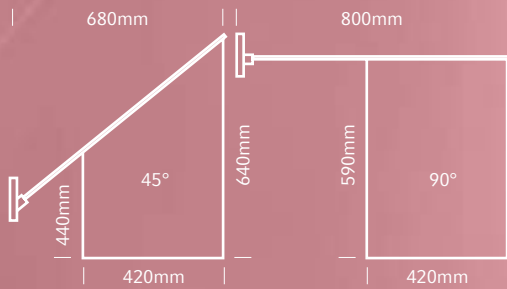

WALL FLAG

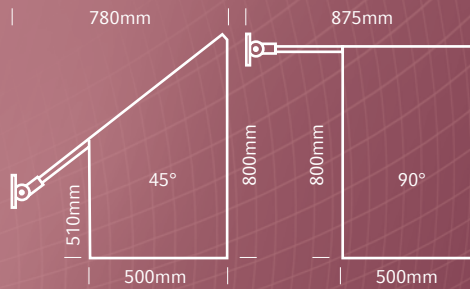

STREET FLAG

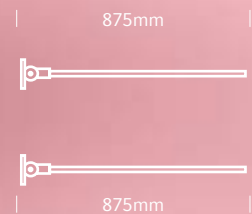

WALL FLAGS

POS FLAGS

Cost effective attention grabbers

- Pole can be used four different ways with same bracket
- Moulded in UV resistant PVC
- PVC panel colours: Blockout White, Yellow
- Panels available with 90° or 45° tops and can be cut to pennant shape

WALL FLAGS

Larger flag for more impact

- Adjustable pole - 13 different positions
- Powdercoated aluminium construction
- PVC panel colours - Blockout White, Black
- Panels available with 90° or 45° tops and can be cut to pennant shape

STREET FLAGS

For use on a pole or wall

- Includes adjustable brackets for mounting to pole
- Can also be screwed to a wall
- Powdercoated aluminium construction
- Flag not included

SIGNHOLDERS



Use in sequence



Use in sequence

WIRE SIGNFRAMES

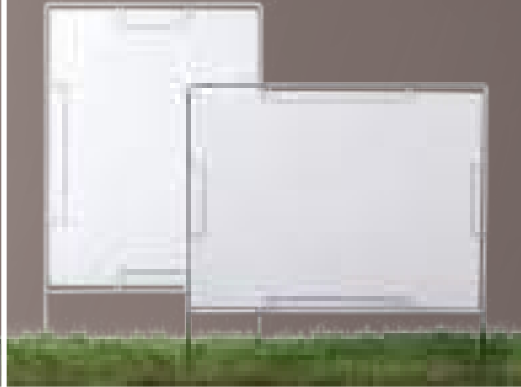

SIGNHOLDER COLOURS



Black



White



Yellow



Red



Dark Blue

Colours are indicative only.

SIGN HOLDERS

SIGNHOLDERS

The tidy effective way to display flute panels

- Moulded in durable UV resistant PVC
- Can be used on paved areas with the hardstand frame
- Gain extra height by using highriser stand. Adds 1100mm height
- Extra effective when used in sequence
- 3mm flute panels
- Panels can be easily changed out
- Frame colours - Black, White, Yellow, Red, Dark Blue
- Panel colours - Black, White, Yellow

SIGNHOLDER

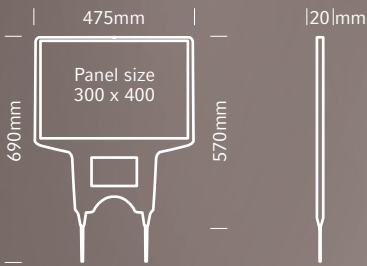

WIRE SIGNFRAME

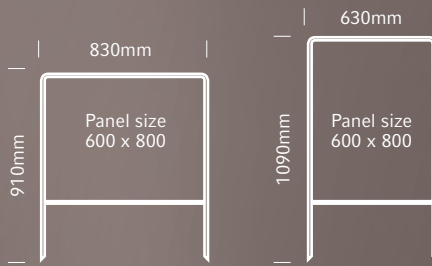

PIGTAIL SIGNSTAKE

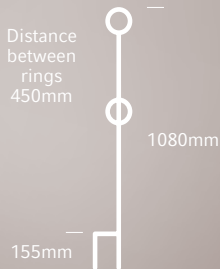

ADJUSTABLE SIGNSTAKES

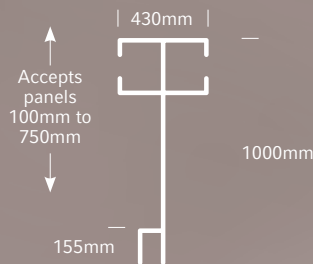

PIGTAIL SIGNSTAKES

ADJUSTABLE SIGNSTAKES

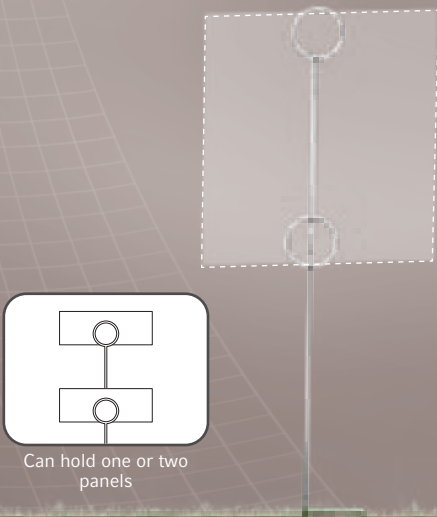

Can hold one or two panels

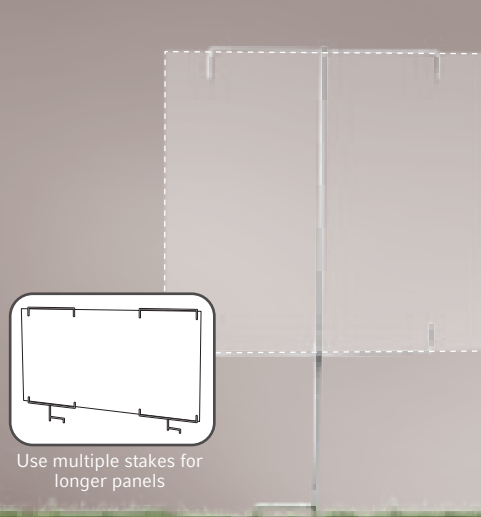

Use multiple stakes for longer panels

WIRE SIGNFRAMES

- Holds panels 600 x 800mm
- Accepts material 3mm to 6mm thick
- Available portrait and landscape
- Anti corrosive plated finish

PIGTAIL SIGNSTAKES

For temporary groundmounted signage

- Holds panels 450mm high or two smaller panels
- Accepts material 2mm to 8mm thick
- Can also be used to create pedestrian lanes
- Anti corrosive plated finish

ADJUSTABLE SIGNSTAKES

Designed to accept a range of panel sizes

- Holds panels 100mm to 750mm high
- Accepts material 2mm to 8mm thick
- Panels should be at least 450mm wide
- Anti corrosive plated finish



AXIS CABLE TENSION SYSTEM

Axis Cable Tension System has been designed to cover a vast range of shelf, panel and display installation applications. All Axis system components are manufactured to the highest standards and finished to enhance your project. Simple to install, easy to change and versatile enough to be used in almost any application.

1.5MM WIRE COMPONENT RANGE

W15 CM
Ceiling Connector
 Cable Spacing:
 Panel/shelf width + 8mm

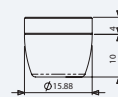

W15 FM
Floor Connector
 Cable Spacing:
 Panel/shelf width + 8mm

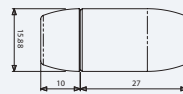

W15 VG6
Vertical Grip
 For panels up to 6mm thick
 Drill 5.5mm hole 12mm from top

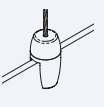
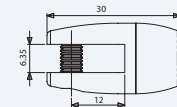

W15 VG10
Vertical Grip
 For panels up to 10mm thick
 Drill 5.5mm hole 12mm from top

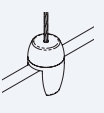
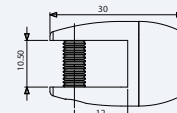

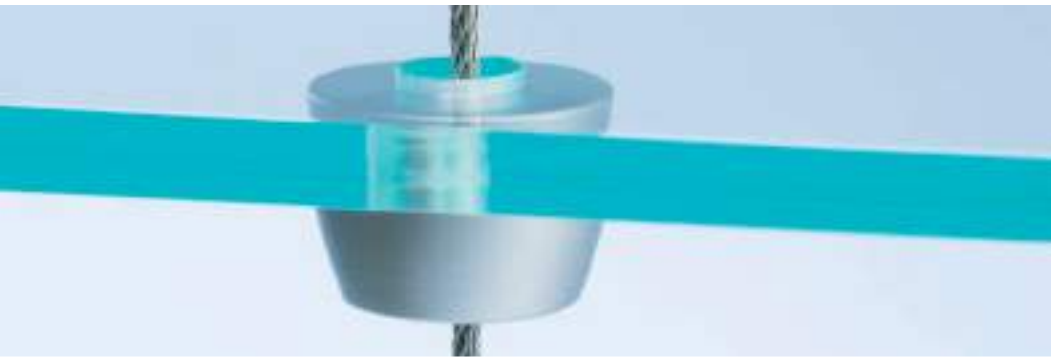

1.5MM WIRE COMPONENT RANGE

W15 PG5

Panel Grip

For panels up to 5mm thick
Cable spacing:
Panel width + 8mm

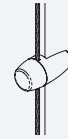
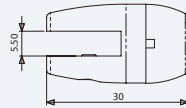
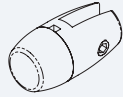

W15 PG8

Panel Grip Large

For panels up to 8mm thick
Cable spacing:
Panel width + 8mm

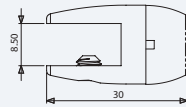
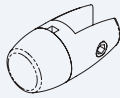

W15 SG5

Shelf Grip

For shelves up to 5mm thick
Cable spacing:
Shelf width + 8mm

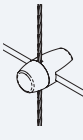
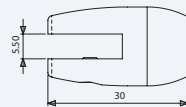
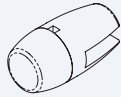

W15 SG8

Shelf Grip Large

For shelves up to 8mm thick
Cable spacing:
Shelf width + 8mm

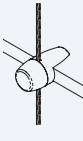
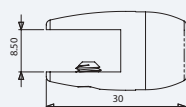
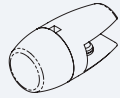

W15 DPG5

Double Panel Grip

For panels up to 5mm thick
Cable spacing:
Panel width + 8mm

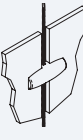
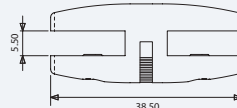
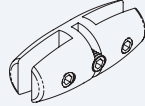

W15 DPG8

Double Panel Grip Large

For panels up to 8mm thick
Cable spacing:
Panel width + 8mm

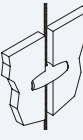
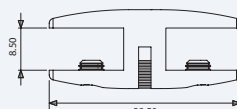
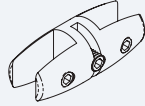

W15 DSG5

Double Shelf Grip

For shelves up to 5mm thick
Cable spacing:
Shelf width + 8mm

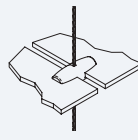
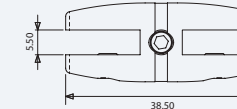
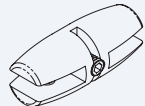

W15 DSG8

Double Shelf Grip Large

For shelves up to 8mm thick
Cable spacing:
Shelf width + 8mm

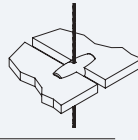
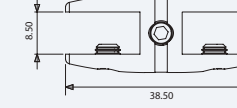
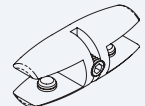

W15 SL

Shelf Locator

Requires 7mm hole
2mm slot optional

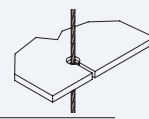

W15 SCC

Swivelling Ceiling Connector

Cable Spacing:
Panel/Shelf width + 8mm

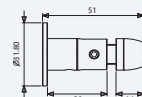

W15 SFC

Swivelling Floor Connector

Cable spacing:
Panel/Shelf width + 8mm

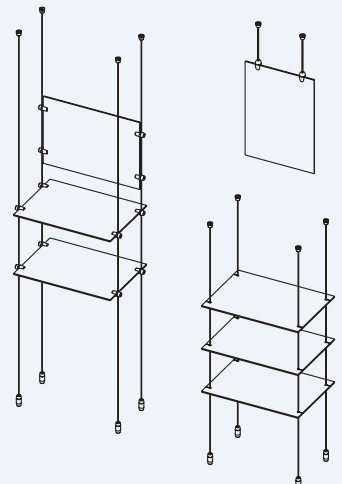
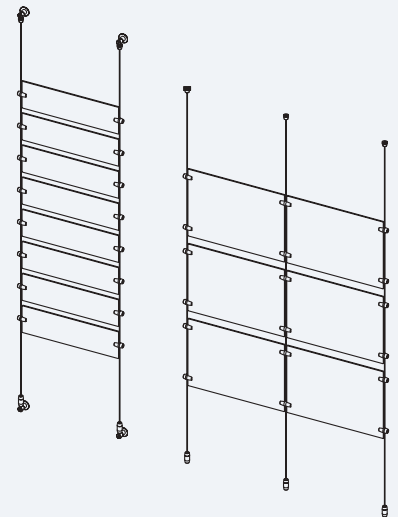
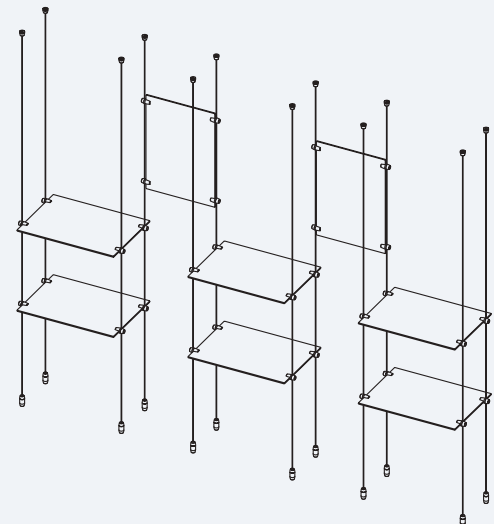
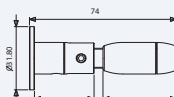

AXIS SIGNMOUNTS

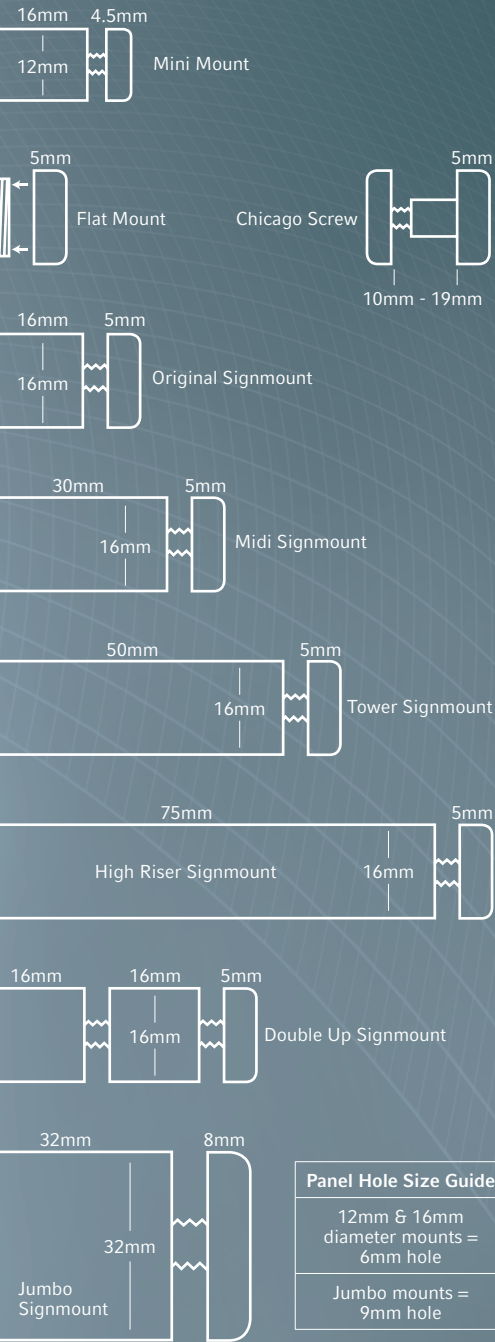

SIGNMOUNTS



INSTALLATION SEQUENCE

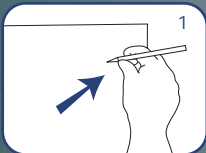

1
Drill holes in panel. Use panel to mark hole positions on wall

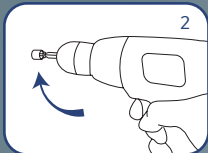

2
Screw threaded cups into place

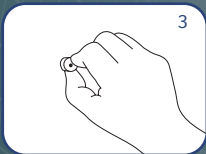

3
Thread standoffs over threaded cups

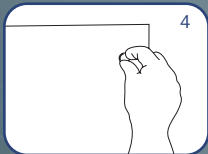

4
Thread thumbscrews through panel into standoffs

AXIS SIGNMOUNTS

Adding class to wallmounted sign panels

- Attractive solution to the challenge of mounting sign panels
- Quick and easy to install
- Available in four different standoff heights as well as Flatmounts and Jumbo Signmounts
- Suitable for panels 2mm thick to 9mm thick
- Long reach thumbscrews available for panels 10mm to 15mm
- Super long reach set up available for panels 16mm to 20mm

AXIS ULTRAMOUNTS

Display posters between two panels

- Same appearance as signmounts
- Designed to allow the poster to be changed out
- Backing panel stays in place when thumbscrews are removed
- Same installation procedure as Signmounts
- Available with 16mm or 30mm standoff

CHANGEOUT SEQUENCE

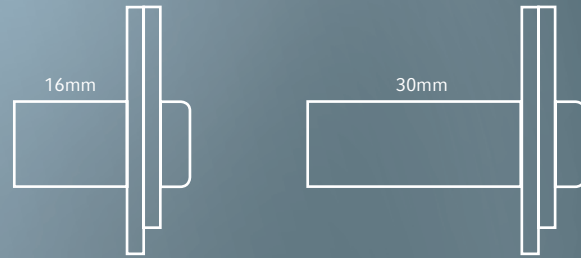
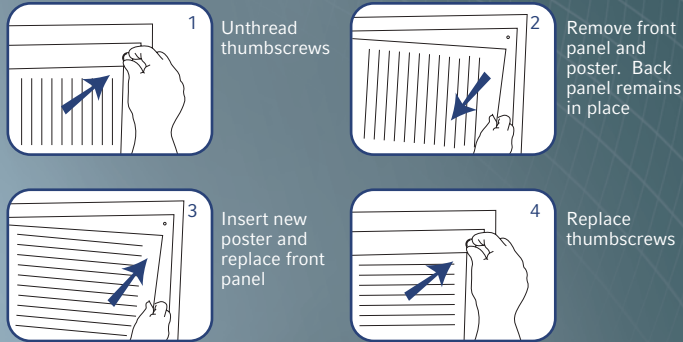

ULTRAMOUNTS



LETTERMOUNTS

AXIS LETTERMOUNTS

The quick, effective way to mount 3-dimensional letters

- UV resistant for interior and exterior use
- Available in two sizes - 15mm and 25mm standoff
- Very easy to install
- Use Loctite 406 to attach to Acrylic letters - see page 29



INSTALLATION SEQUENCE

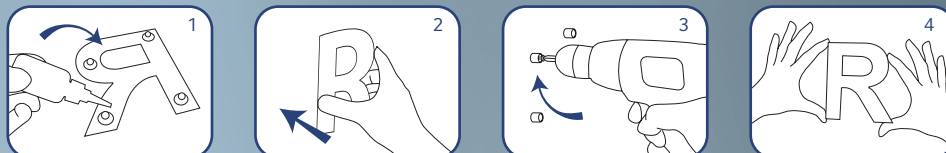

Adhere ball part to back of letters

Place letter on wall in desired position. Centre spikes on ball part will mark positions for cup part

Screw cup parts to wall

Pop letters into place

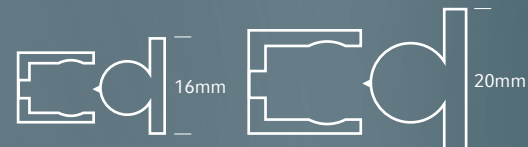

Standard - 15mm standoff

Jumbo - 30mm standoff

CUBEMOUNT



CUBEMOUNT

The versatile panel mounting system

- Four uses from one mount - wall mount, projecting, counter top and ceiling mount
- Suitable for panels up to 6mm thick
- Quality satin aluminium finish
- Six lengths available - 60mm, 100mm, 150mm, 200mm, 300mm and 400mm

Four uses from one mount

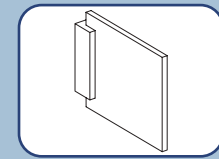

Projecting (pictured)

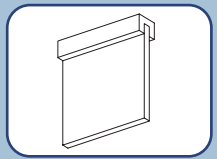

Ceiling mount

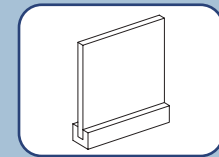

Counter top

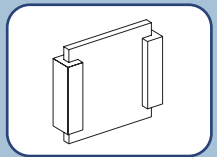

Wall mount



CUBEMOUNT

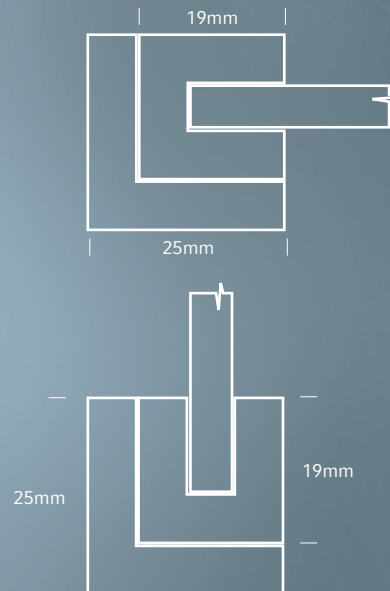

INSTALLATION SEQUENCE

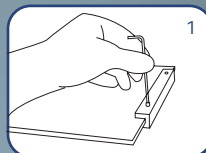

1 Attach U section to edge of panel

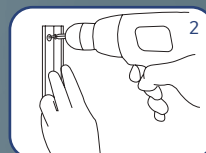

2 Screw L section to wall

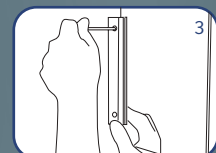

3 Attach U section to L section

POSTER HANGERS

POSTER SNAP

Wallmounted or hanging poster display solution

- Stylish silver anodised finish
- Suitable for single and double sided applications
- Accepts material from paper to 2mm panels
- Ideal for fabric & PVC prints
- Sold in sets - Top rail, bottom rail, end caps and hanger clips
- Can be wallmounted or suspended
- Snap open and snap shut to change posters
- Two stock sizes - 1200mm and 2400mm
- Can be cut down using standard aluminium cutting tools



Snap open and shut to change out

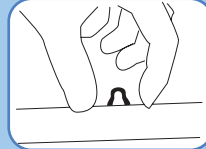

Adjustable hanger clips



Poster Snap



Rectangular Aluminium Banner Rail



Round Aluminium Banner Rail

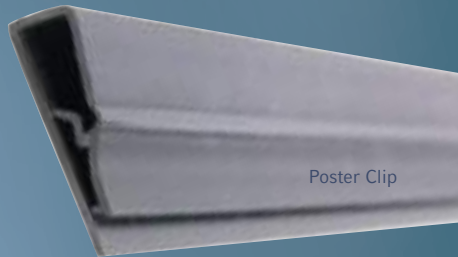

Poster Clip

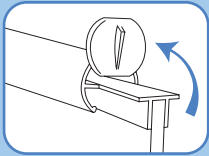

Easy change out

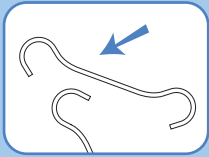

Hang with double ended hooks - 4 sizes available

ALUMINIUM BANNER RAIL

Hanging poster display solution

- Stylish silver anodised finish
- Suitable for single and double sided applications
- Accepts material from paper to 2mm panels
- Sold in sets - Top rail, bottom rail, end caps, hanger clips and poster grippers
- Two profiles - round and rectangular
- Five stock sizes - 600mm, 800mm, 1200mm and 2400mm
- Can be cut down using standard aluminium cutting tools

POSTER CLIP

Wallmounted poster display solution

- Easily changed out
- Accepts material from paper to 3mm panels
- Available in 2500mm lengths - easily cut to length
- Stock colour - Black

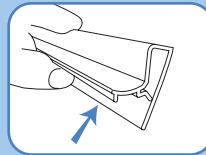

Quick easy change out

POSTER HANGERS

Drawn to actual size

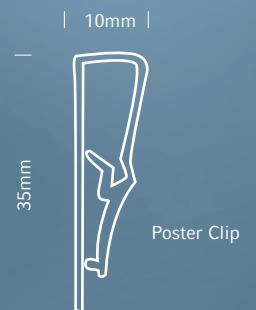
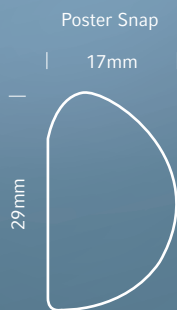

ACCESSORIES

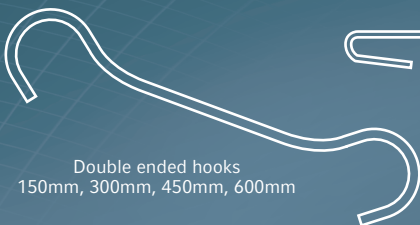

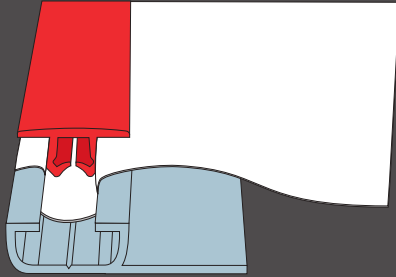

S-FLEX MEDIA TENSIONING SYSTEM

S-Flex is a lightweight, low profile tensioning system that can be used with almost any type of flexible media and tensions without the need for specialised tools. S-Flex is suitable for a huge range of applications including large outdoor signage, retail and exhibition signage and can also be retro fitted to existing lightboxes.

The S-Flex System is compatible with most commercially available flexible media, including PVC; frontlit and backlit, mesh, canvas, textiles and many other substrates. It is recommended to use media between 450gsm and 600gsm.

- Quick and easy to install
- No specialised tools required
- Flexible media can be changed out
- Available in 3m lengths for easy transportation
- Suitable for signage up to 20m long x 5m high
- Three different sections available for different applications



S-FLEX CROSS SECTIONS



F Section

- **F SECTION** This profile is used where larger or stronger fixings are required. The tail strip provides the space needed for fixing the frame to the mounting surface. This section is more tailored for use on outdoor sites like exterior walls, larger signage frames and rigid truck bodies.



Y Section

- **Y SECTION** This design is used to make up complete structural frames. Graphics can be printed, then tensioned and delivered complete to site for hanging. Frames can be mounted back-to-back for double sided graphics.



C Section

- **C SECTION** This frame is a lightweight solution to install flexible graphics which require smaller fixings. Ideal for use on lightboxes for backlit graphics.



PVC Tension Strip

- **PVC TENSION STRIP** This profile is inserted into the aluminium frame to fix the flexible substrate in position and simultaneously create the tension required.

PIVOT PRICERS

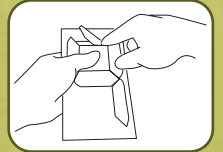

Easy to change

PIVOT PRICERS & SLOT SIGNS

PIVOT PRICERS

The easiest changeable pricing and numbering system available

- Easy to read
- Rotate the sections by hand to form any number
- Suitable for interior and exterior use
- Completely self-contained - no loose components
- Available in five letter heights - 30mm, 60mm, 80mm, 160mm and 240mm

SLOT SIGNS

Changeable projecting signs

- Durable powdercoated aluminum and PVC construction
- Panel can be removed - no tools required
- Stock colour - White bracket and panel
- Interchangeable panels available
- 15 stock sizes - cut down panels to achieve non stock sizes

SLOT SIGN

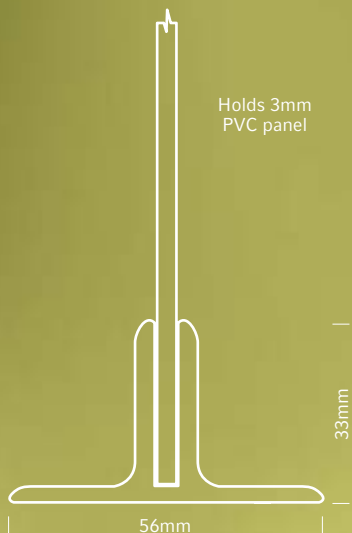

SLOT SIGN

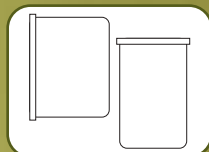

Can be used vertically or horizontally

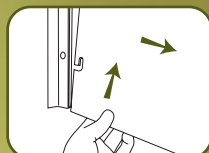

Easily detachable



LIGHT BOX

CONVEX LIGHT BOX

Stylish, interior changeable lightboxes

- Silver anodised aluminium construction
- Side profiles snap open for poster changeout
- Display posters or transparencies
- Stock sizes - A2, A1 and A0

WHITE BOARD

MAGNETIC WHITEBOARDS

Aluminium framed

- 10 standard sizes
 - Special sizes on request
 - Anodised aluminium frame for extra strength
 - All wall fixings included
- | | |
|------------|--------------|
| 450 x 600 | 1200 x 1200* |
| 600 x 600 | 1200 x 1500* |
| 600 x 900 | 1200 x 1800* |
| 600 x 1200 | 1200 x 2400* |
| 900 x 1200 | 1200 x 3600* |

* Actual outside dimensions - all other sizes are whiteboard panel dimensions

CONVEX LIGHT BOX

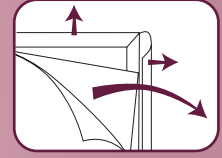

Quick easy poster changeout

“Maximum impact, even on dull days, and changes out in seconds”

WHITE BOARD



WHITE BOARD

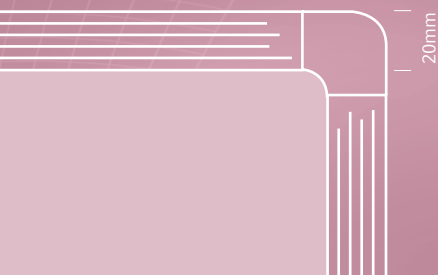

PAPYRUS FRAME



POSTER DISPLAYS

PAPYRUS FRAME

Paper display system

- Smart clean design
- Stylish silver anodised finish
- Paper inserts change out easily
- Three stock sizes - 60mm x 210mm, A4 and A3
- * Virtually impossible to open without suction tool

CLASSIC CLICKFRAME



CLASSIC CLICKFRAME

Classic style clickframe with silver corners

- Made to request
- Custom sizes can be made to your requirement
- 30mm Profile frame

SECURICLICK

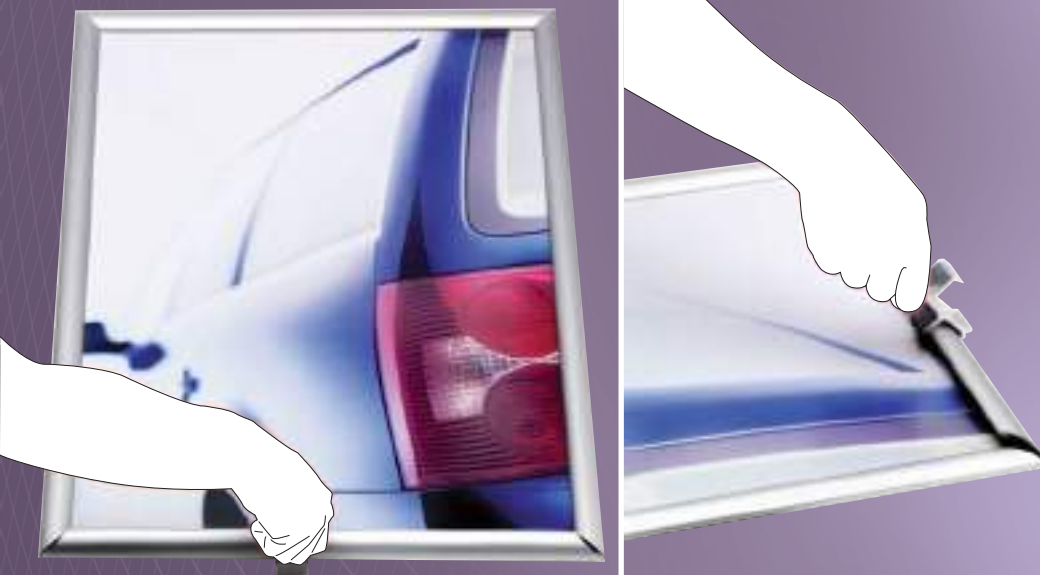

SECURICLICK

Unable to be accessed without the changeout tool

- Stylish silver anodised finish
- Anti-reflective, clear covers
- Four stock sizes - A4, A3, A2 and A1
- 25mm profile frame

EURO CLICKFRAME



SIZING GUIDE

Euro Clickframe		
Panel Size	Visual Area	Outside Size
A4	190 x 280	250 x 340
A3	278 x 402	338 x 462
A2	400 x 576	460 x 636
A1	574 x 822	634 x 882
A0	821 x 1169	881 x 1229

“Euro Clickframes exceed our expectations for quality store fittings”

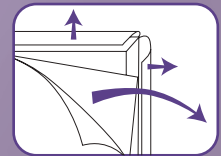

Easy access to change posters

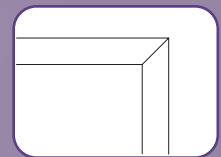

Mitred corners

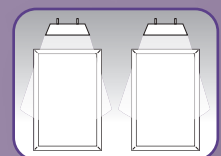

Non reflective clear covers included

FRAMES

EURO CLICKFRAME

Front loading snap frames

- Quick and easy to change posters
- Stylish silver anodised finish
- Anti reflective clear cover
- Five stock sizes - A4, A3, A2, A1 and A0
- 30mm Profile frame

LOCKABLE POSTER FRAMES

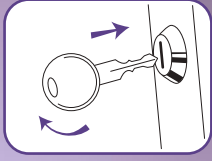

Lockable

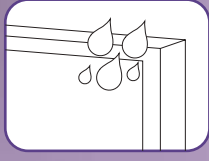

Weatherproof

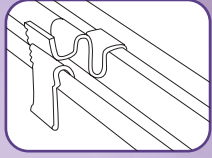

Includes poster holding clips

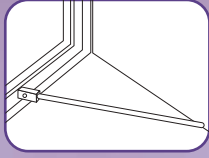

Door stays for easy poster mounting



MAGNETIC NOTICEBOARDS

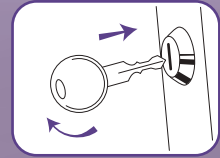

Lockable



Weatherproof

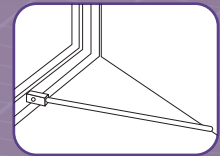

Door stays for easy poster mounting

AND NOTICEBOARDS

LOCKABLE POSTER FRAMES

- Suitable for interior and exterior use
- 100% weatherproof
- Anodised aluminium frame
- Four stock sizes - A3, A2, A1 and A0

MAGNETIC NOTICEBOARD

Secure weather resistant noticeboards

- Suitable for interior and exterior use
- 100% weatherproof
- Anodised aluminium frame
- One set of magnets included
- Four stock sizes - 4, 6, 9 or 12 A4 paper capacity

SIZING GUIDE

Lockable Poster Frames		
Panel Size	Visual Area	Outside Size
A3	277 x 400	367 x 490
A2	400 x 574	490 x 664
A1	574 x 821	664 x 911
A0	821 x 1169	911 x 1259

Magnetic Noticeboards		
Panel Size	Visual Area	Outside Size
4 x A4 cap.	620 x 450	760 x 590
6 x A4 cap.	940 x 450	1080 x 590
9 x A4 cap.	940 x 680	1080 x 820
12 x A4 cap.	940 x 910	1080 x 1050
External depth - 50mm Internal depth - 23mm		

FREE STANDING BROCHURE HOLDER



Weighted base

FREE STANDING MENU BOARD

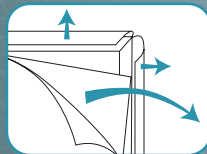

Easy poster changeout

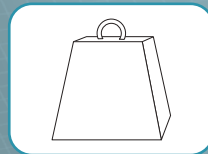

Weighted base

FREE STANDING BROCHURE HOLDER

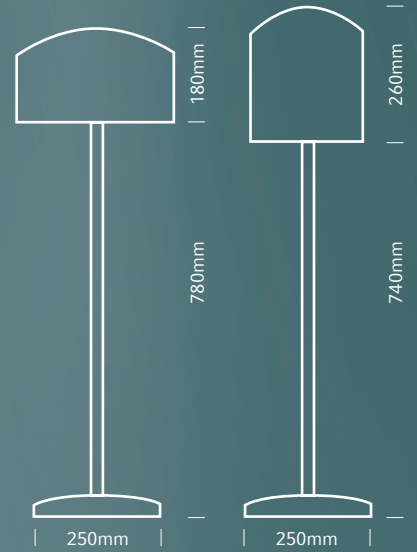

SALEBLAZER

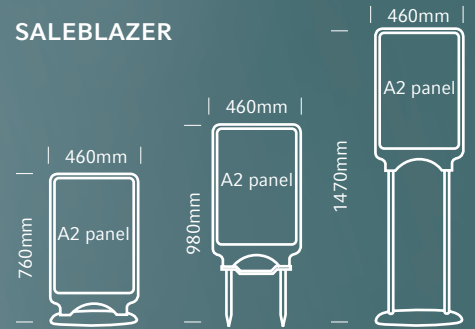

SALEBLAZER



Groundmount Extender

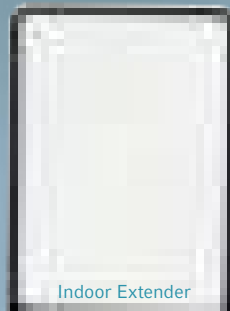

Indoor Extender



Outdoor Extender

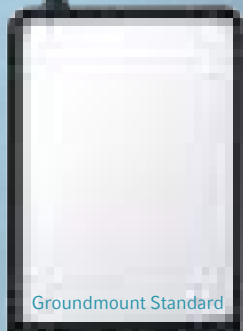

Groundmount Standard

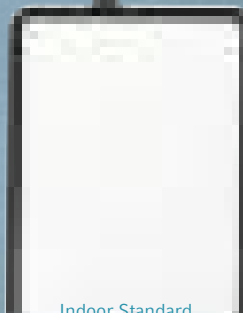

Indoor Standard

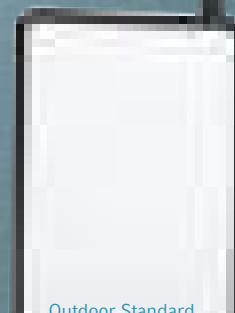

Outdoor Standard

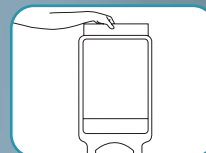

Top loading

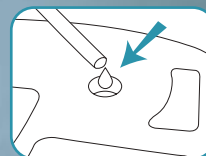

Water fillable base option

FREE STANDING MENU BOARD

A2 landscape shown

Available with A2 & A3 landscape or portrait

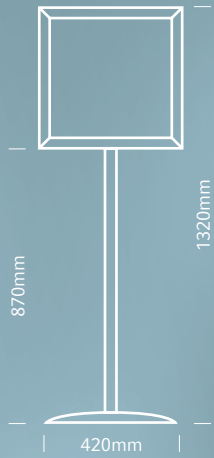

FREE STANDING LEAFLET DISPLAY



FREE STANDING LEAFLET DISPLAY

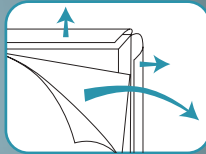

Easy poster changeout

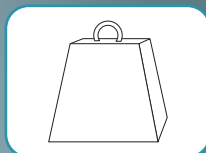

Weighted base



DISPLAY OPTIONS

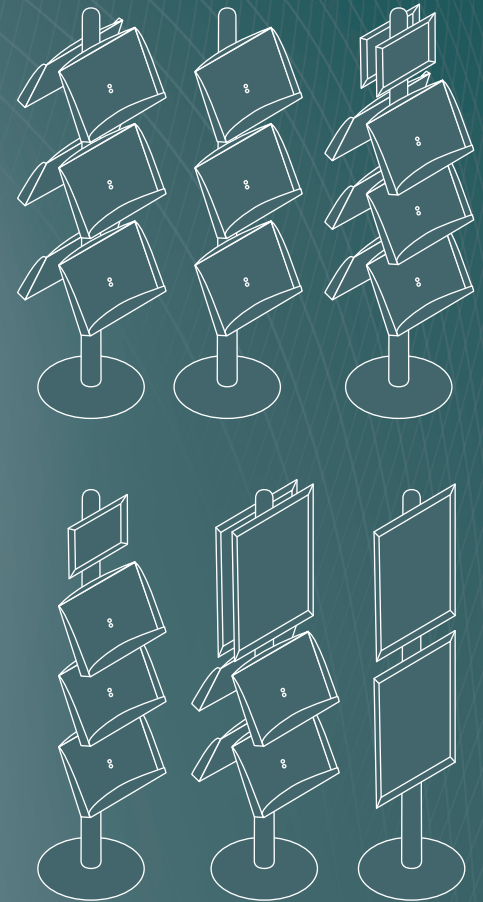

“The modular design of the Leaflet Displays is great for our dealers. Each one can be tailored to suit”

DISPLAY STANDS

FREE STANDING BROCHURE HOLDER

Attractive A4 brochure holder

- Silver anodised aluminium frame
- Polycarbonate brochure holder
- Weighted base
- Stock sizes - A2. Landscape or portrait

FREE STANDING MENU BOARD

Stylish and functional poster and menu holder

- Silver anodised aluminium finish
- Weighted base
- Snap open snap shut changeout
- Anti reflective clear cover
- Stock sizes - A4 and A3. Landscape or portrait

SALEBLAZER

A2 poster and panel display frames

- Top loading - posters slide into frame
- Six different configurations available - Groundmount Standard, Groundmount Extender, Indoor Standard, Indoor Extender, Outdoor Standard, Outdoor Extender
- Available with clear poster panels, white PVC panels or corflute panels
- Stock colour – Black

FREE STANDING LEAFLET DISPLAY

Modular Clickframe & Brochure Display system

- Single or double sided
- Weighted base for stability
- Silver anodised aluminium construction
- Use Clickframes and/or Brochure Holders to suit

iLOOK BANNER STAND

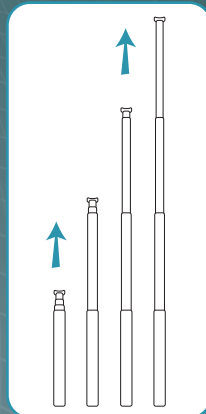

Telescopic pole for adjustable height

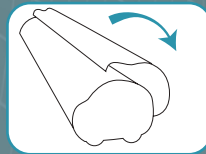

Base opens for easy changeout

“The iLook Banner Stand is the most user-friendly roll up we have ever used”

iLOOK BANNER STAND

Easy load, roll up banner display

- Base hinges open for easy loading
- Unique snaplock PVC holder for quick, easy loading
- Accepts all flexible media from paper to PVC
- Change the banner as often as required without any damage to the print or the banner stand
- Telescopic pole for infinitely variable heights from 1200mm to 2100mm
- Comes with carry case on wheels
- Silver anodised aluminium finish
- Four stock widths - 600mm, 900mm, 1200mm and 1500mm

QUICK BANNER STAND

- Quick and easy clamp banner loading system
- Accepts all flexible media from paper to PVC
- Change the banner as often as required without any damage to the print or the display
- Comes with carry bag
- Silver anodised aluminium finish
- Banner height 2000mm
- Two stock widths - 800mm and 1000mm

QUICK BANNER STAND

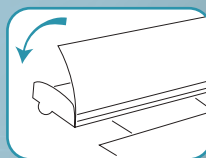

Clamp banner retention system

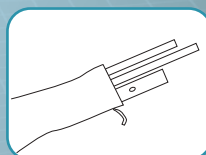

Folds down for compact storage

iLOOK BANNER STAND

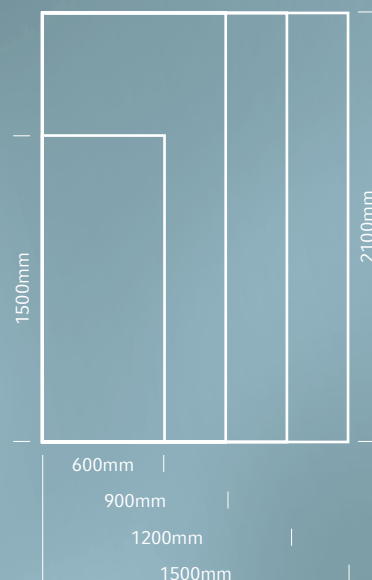

QUICK BANNER STAND

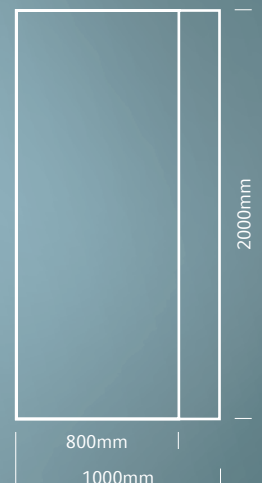

HINGE HANDLES



A BOARD PIVOTS



HOLD ONS



HINGE HANDLES

- For A Boards. Board can be flipped over to utilise reverse side. Available in two widths 305mm and 406mm. All fittings supplied

A BOARD PIVOTS

- Simple and effective pivot system for A Boards. Plastic and stainless steel components mean no rusty parts. Includes stainless steel mounting screws for 10mm panels

HOLD ONS

- Unique yet simple nylon clip on banner eyelets. The stronger the force against the banner the stronger they hold
- Stock colour – white

POWER TABS



SUCTION CUPS



LOCTITE 406



POWER TABS

- Self adhesive power tabs turn posters and digital prints into banners instantly. No sewing, grommeting or special tools required

SUCTION CUPS

- Ideal for mounting lightweight signs, banners or displays to any smooth surface. Three styles available Thumbtack, Hook and Threaded. 45mm diameter

LOCTITE 406

- For a superior, chemical bond on PVC, and acrylic. Ideal for use with Lettermounts.

PVC TAPE



UHB TAPE



VALERON PAPER



PVC DOUBLE SIDED TAPE

- High adhesion to a variety of surfaces
- Suitable for interior and exterior use. Available in 12mm, 18mm, 24mm widths. 50m rolls

UHB DOUBLE SIDED TAPE

- Ultra high bond tape for a superior bond to almost any substrate. High density, pressure sensitive tape 1mm thick
- Available in 12mm, 18mm and 25mm widths. 33m rolls

VALERON COATED PAPER

- Ultra tough waterproof paper. Will not rip and is UV stable. Ideal for banners, hangers, pennants etc. 665mm and 1330mm widths. 241gsm.

ULTRO 900

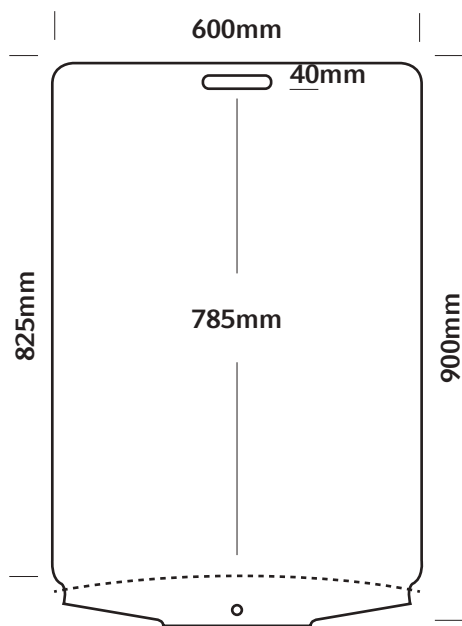

- CX9 powdercoated aluminium panels available in White, Black, Yellow, Dark Blue, Tomato Red and Metallic Silver
- Steel powdercoated panels available in White and Black
- PVC panels

ULTRO 800

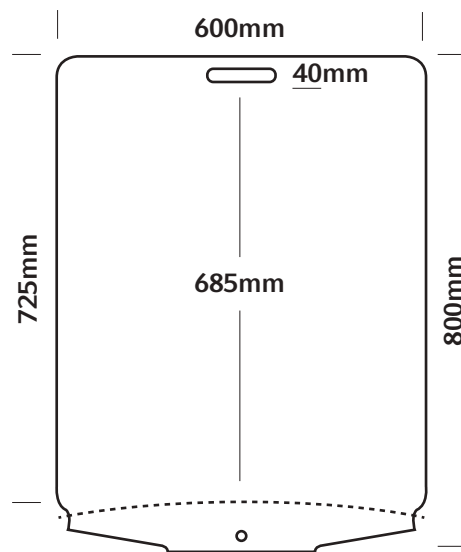

- PVC Panels

INFORMER 900

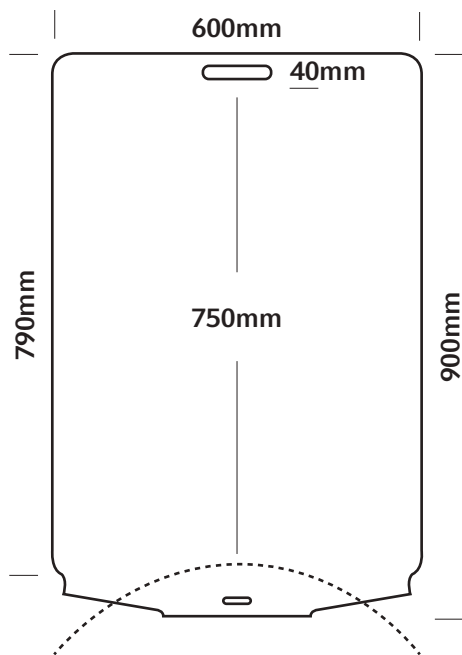

- CX9 powdercoated aluminium panels available in White, Black, Yellow, Dark Blue and Metallic Silver
- PVC panels

INFORMER 800

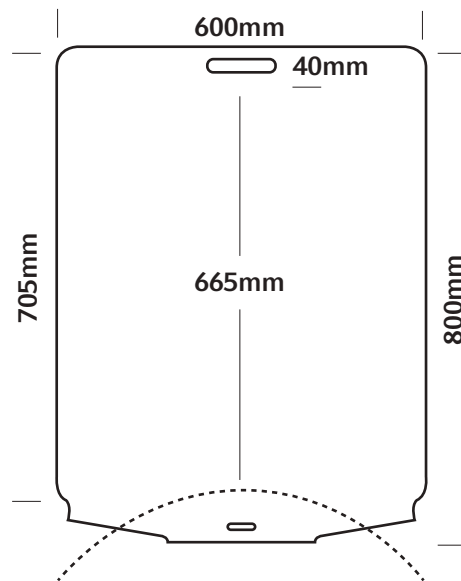

- PVC Panels

EXECUTIVE 900

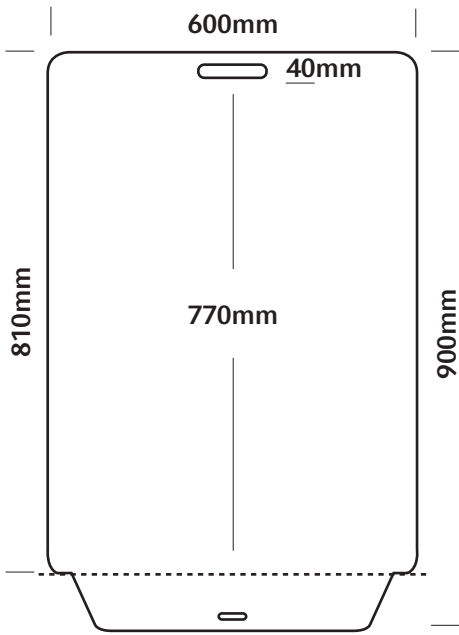

- PVC Panels

EXECUTIVE 800

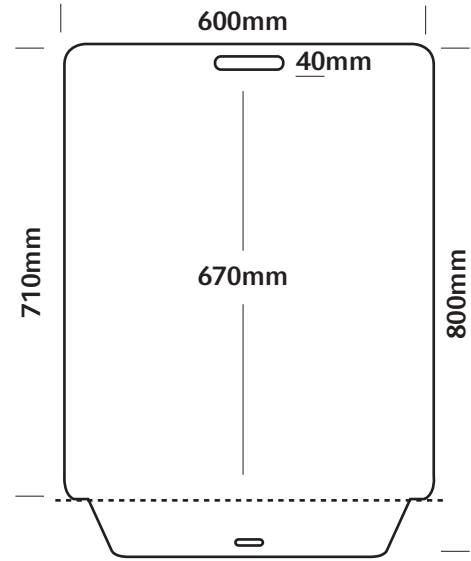

- PVC Panels

ORBIS SPINNING SIGN

DIRECTOR 800

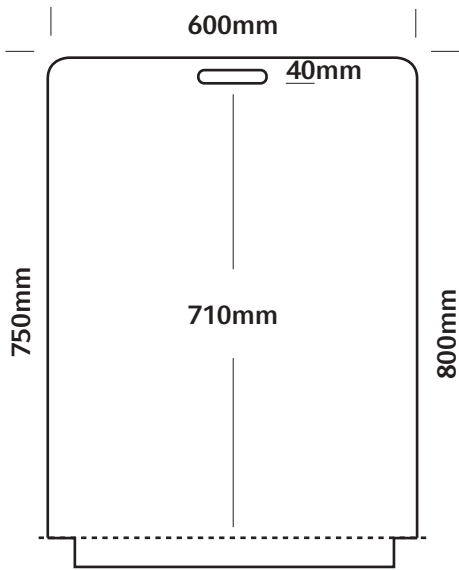

- PVC Panels

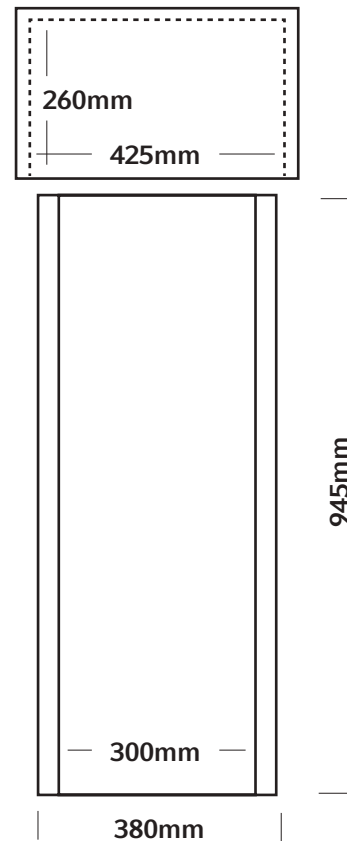

- PVC Panels